

Warning: Split waterstop is for straight runs only; no change of directions are possible

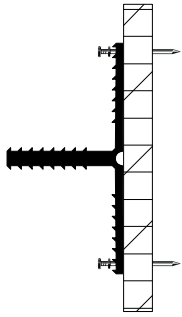

1) Nail waterstop to formwork using double-headed nails.

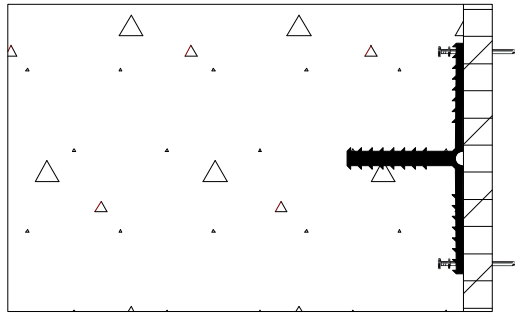

2) Cast first pour of concrete.

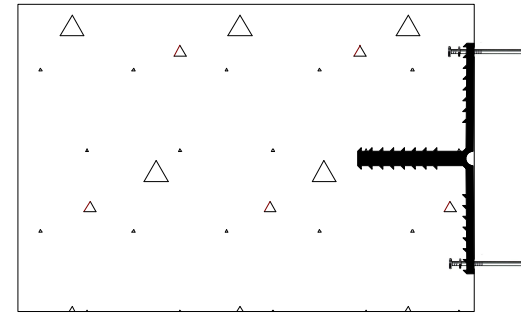

3) Carefully remove the formwork.

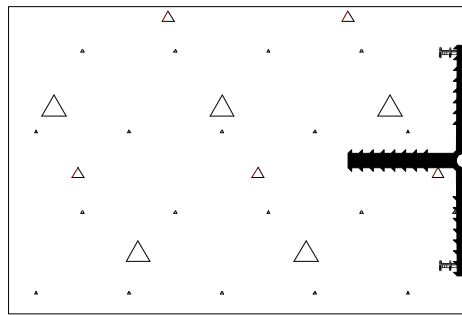

4) Clip off the exposed nails.

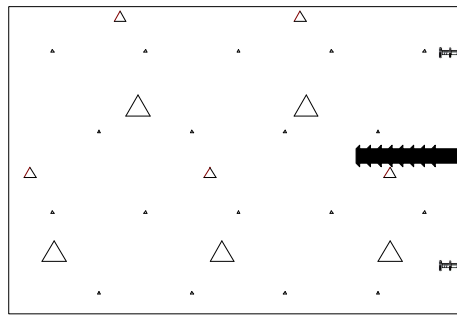

5) Bring the legs together.

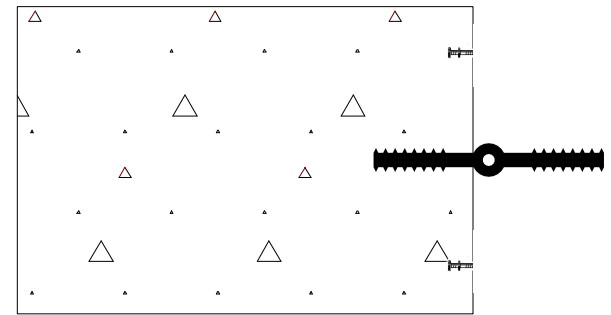

6) Glue the two waterstop halves using contact adhesive.

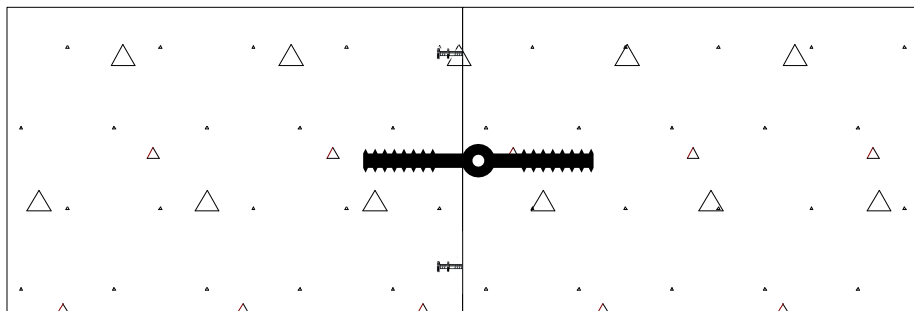

7) Cast the second pour of concrete.

J P Specialties, Inc. / Earth Shield® Waterstop 25811 Jefferson Avenue, Murrieta, CA 92562 951-763-7077 • www.jp-specialties.com		
TITLE		
<i>How to Install Split RCB Waterstop</i>		
PART NUMBER	DRAWN BY	DATE
	DRP	09/18
CAD FILE NAME	APPROVALS	SIZE
How to Install Split RCB Waterstop		LTR