

1) Prepare existing concrete by grinding away any irregularities.

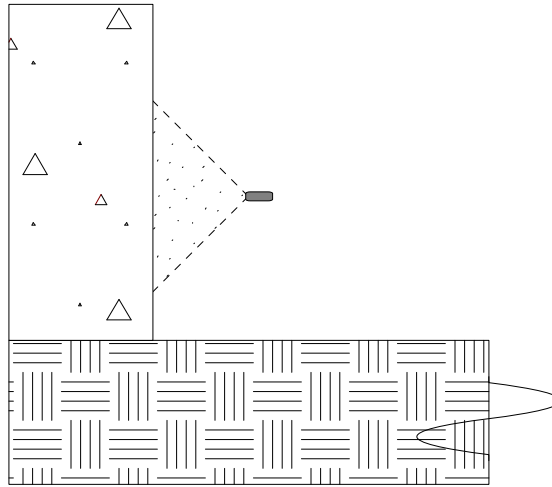

2) Thoroughly clean existing concrete using a wire brush, high pressure waterblast, or sand blast.

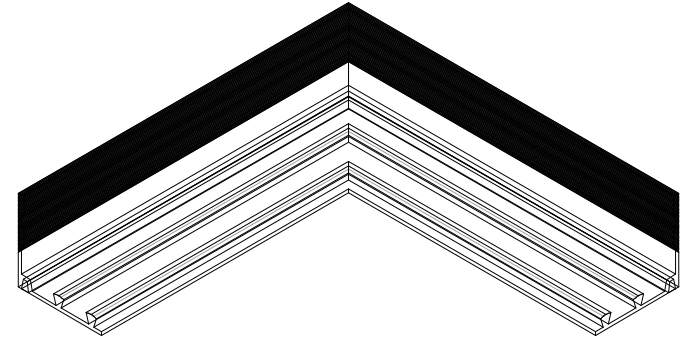

3) Heat weld waterstop profile to appropriate length and directional changes to fit concrete surface.

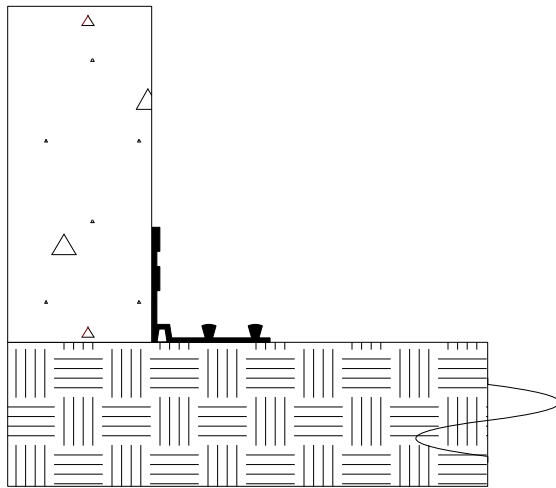

4) Check heat welded waterstop for proper location, orientation and fit.

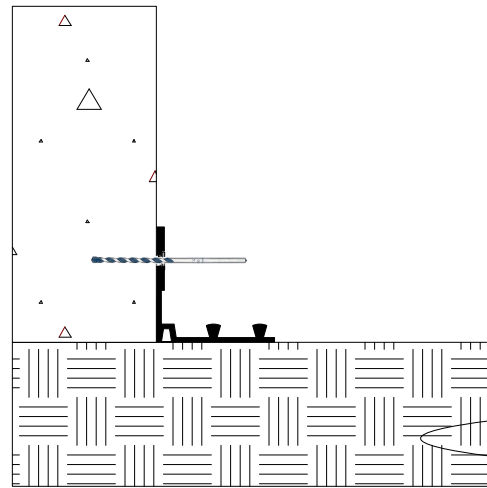

5) Using the prepunched stainless steel batten bar as a template, drill 1/4" holes 2-3/4" deep through waterstop and concrete. Clean out holes.

| | | |
|--|------------------------|----------------------|
| J P Specialties, Inc. / Earth Shield® Waterstop 25811 Jefferson Avenue, Murrieta, CA 92562 951-763-7077 • www.jp-specialties.com | | |
| TITLE JP216L Retrofit Install | | |
| PART NUMBER | DRAWN BY DRP | DATE 09/18 |
| CAD FILE NAME JP216L Retrofit Install | APPROVALS | SIZE A |

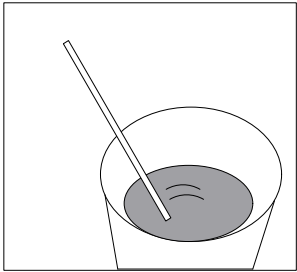

6) Mix appropriate amount of epoxy per mixing instructions on epoxy can.

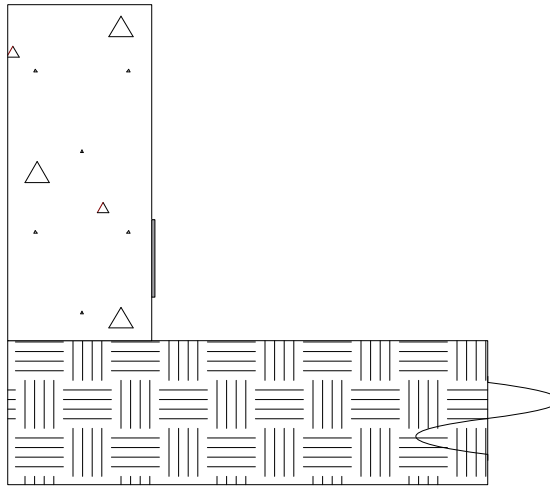

7) Place epoxy strip 1/8" deep by 3" wide on concrete surface at designated location.

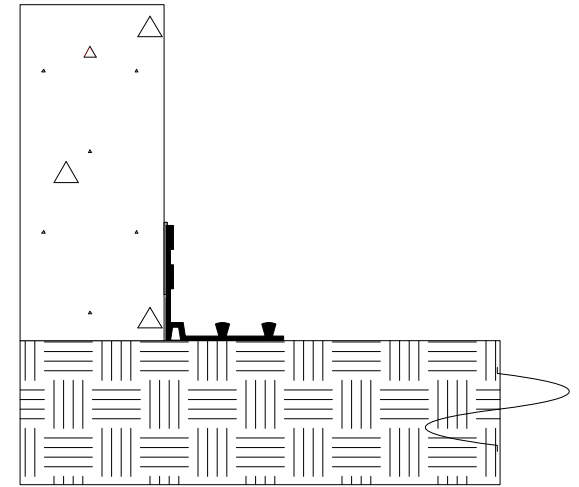

8) Embed waterstop into strips of uncured epoxy.

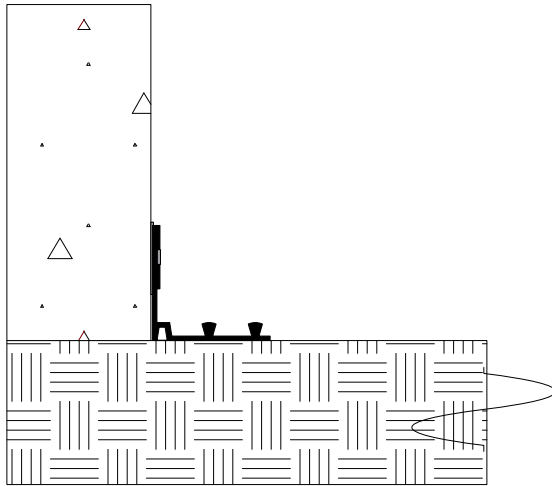

9) Place stainless steel batten bar in recesses of retrofit waterstop.

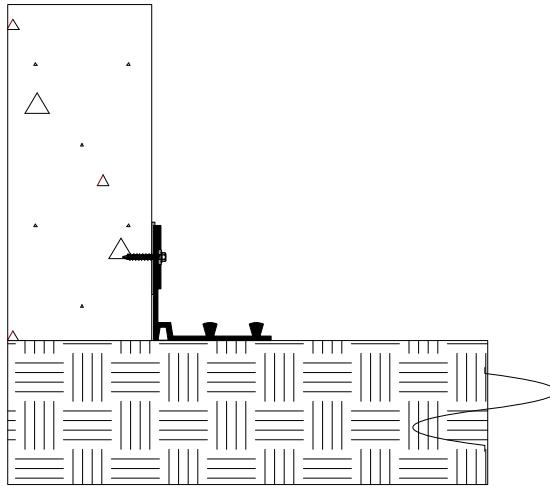

10) Install fasteners through predrilled holes in batten bar and waterstop and tighten as required.

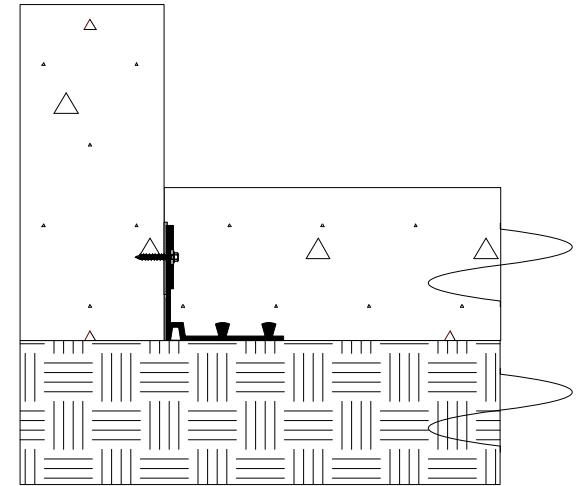

11) Allow installed retrofit waterstop system to cure for 24 hours before placing the second pour of concrete.

For welding, fabrication, placement, execution, and quality assurance please follow all procedures stated in Earth Shield® Master Specification Section 03250.